

English:

- Mount protection on the motorcycle as shown in the assembly instruction and torque all screws to the correct value.

Français:

- Monter la protection sur la moto comme indiqué dans les instructions de montage et torquer toutes les vis avec le bonne valeur.

Português:

- Montar a proteção na moto como a instrução de montagem e apertar todos os parafusos com o valor correto de torque.

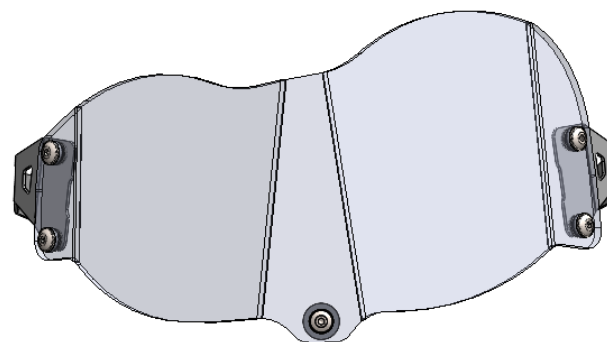

**HEAD LIGHT
PROTECTOR TRANSPARENT**
Ref.: 2CP2210103



Assembly Booklet / Paper collection
Livret de montage / Collecte de papier



Mini Zip Bag / Plastic collection
Mini sac zip / Collecte de pastique



Box / Paper collection
Boîte / Collecte de papier



Carton Separator / Paper collection
Séparateur de cartons / Collecte de papier



Card Header / Paper collection
Carte d'en-tête / Collecte de papier



Plastic Bag Cover / Plastic collection
Couverte de sac en plastique / Collecte de plastique



ID.022.02

ASSEMBLY INSTRUCTION / INSTRUÇÃO DE MONTAGEM

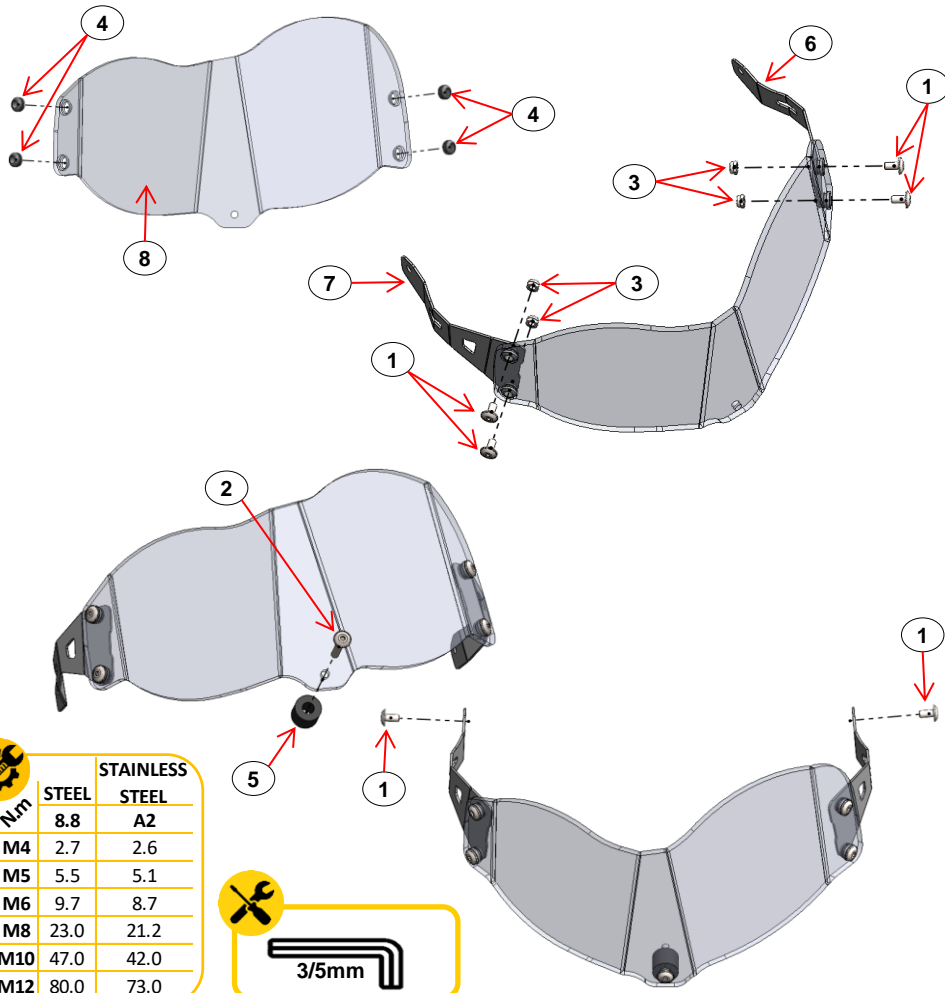

Num	STAINLESS	
	STEEL	STEEL
	8.8	A2
M4	2.7	2.6
M5	5.5	5.1
M6	9.7	8.7
M8	23.0	21.2
M10	47.0	42.0
M12	80.0	73.0

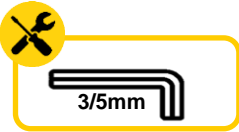

8	Prot. Farol Policarbonato / Polycarbonate Headlight Protector	103	1
7	Fixação Inox / Stainless Steel Clamp	R103	1
6	Fixação Inox / Stainless Steel Clamp	L103	1
5	Casquilho DTC / DTC Bushing	Ø18xØ8x15	1
4	Anilha Especial Borracha / Special Rubber Washer	REF.: 05616632 005 25	4
3	Porca Freada / Nut Nylock	M5 - DIN 985 A2	4
2	Parafuso com FA / Screw with Washer False	M5x35 - ISO 7380 A2	1
1	Parafuso com FA / Screw with Washer False	M5x10 - ISO 7380 A2	6
ITEM Nº:	COMPONENTE (COMPONENT):	DESCRIÇÃO (DESCRIPTION):	QUANT.:
ACESSÓRIOS (ACCESSORIES)			



- English:**
 • Remove OEM screw – left side.
- Français:**
 • Retirer le vis OEM – côté gauche.
- Português:**
 • Remover parafuso OEM – lado esquerdo.

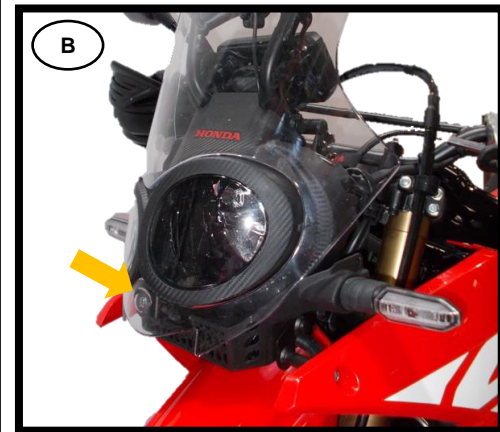

- English:**
 • Remove OEM screw – front side.
- Français:**
 • Retirer le vis OEM – côté avant.
- Português:**
 • Remover parafuso OEM – parte da frente.

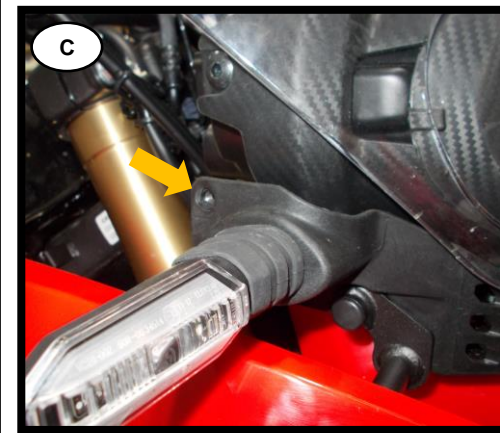

- English:**
 • Remove OEM screw – right side.
- Français:**
 • Retirer le vis OEM – côté droit.
- Português:**
 • Remover parafuso OEM – lado direito.